

1
2
3
4
5
6
7
8
9
10
11
12
13
14
15
16
17
18
19
20
21
22
23
24
25
26

**TORRANCE COUNTY
BOARD OF COUNTY COMMISSIONERS
RESOLUTION NO. R 2019- 32**

**A RESOLUTION SPLITTING THREE EXISTING TORRANCE COUNTY PRECINCTS
AND CREATING THREE NEW TORRANCE COUNTY PRECINCTS**

WHEREAS, NMSA (1978) § 1-3-1-B requires a precinct to be divided if there were 750 votes cast by voters in that precinct in a general election based on the two most recent general elections, or there are more than 2,500 persons residing in the precinct; and

WHEREAS, precincts 5, 6, and 13 were found to have met the criteria set forth in statute that require precincts to be split; and

WHEREAS, Torrance County Clerk Linda Jaramillo along with Research and Polling, Inc. of Albuquerque developed a plan to split precincts 5, 6, and 13, and create precincts 17, 18, and 19; and

WHEREAS, on May 22nd, 2019, the County Clerk presented to the Commission four plans to split precincts 5, 6, and 13 including two versions for precinct 5, one named "Precinct 5" and a second named "Precinct 5 Revised"; and

WHEREAS, the Torrance County Commission approved precinct boundary changes as described in the attached maps including the map labeled "Precinct 5 Revised" and "Precinct 17 Revised"; and

WHEREAS, NMSA (1978) § 1-3-5 requires the Commission to adopt precinct boundary changes via resolution;

NOW, THEREFORE BE IT RESOLVED that the Torrance County Commission does hereby adopt the precinct boundary changes splitting precinct 5 and creating precinct 17;

1 splitting precinct 6 and creating precinct 18; and splitting precinct 13 and creating precinct 19 as
2 described by the attached precinct boundary maps.

3 **DONE THIS 12th DAY OF JUNE, 2019.**

4
5
6

7 **APPROVED AS TO FORM ONLY:**

BOARD OF COUNTY COMMISSIONERS

8
9 *[Signature]* 6/12/19
10 County Attorney Date

[Signature]
11 Ryan Schwebach, Chair

[Signature]
12 Kevin McCall, Member

[Signature]
13 Javier Sanchez, Member

14 **ATTEST:**
15 *[Signature]*
16 Linda Jaramillo, County Clerk

17
18 Date: 6/12/19
19

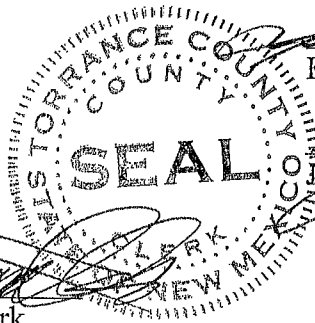

Torrance County Precinct 6

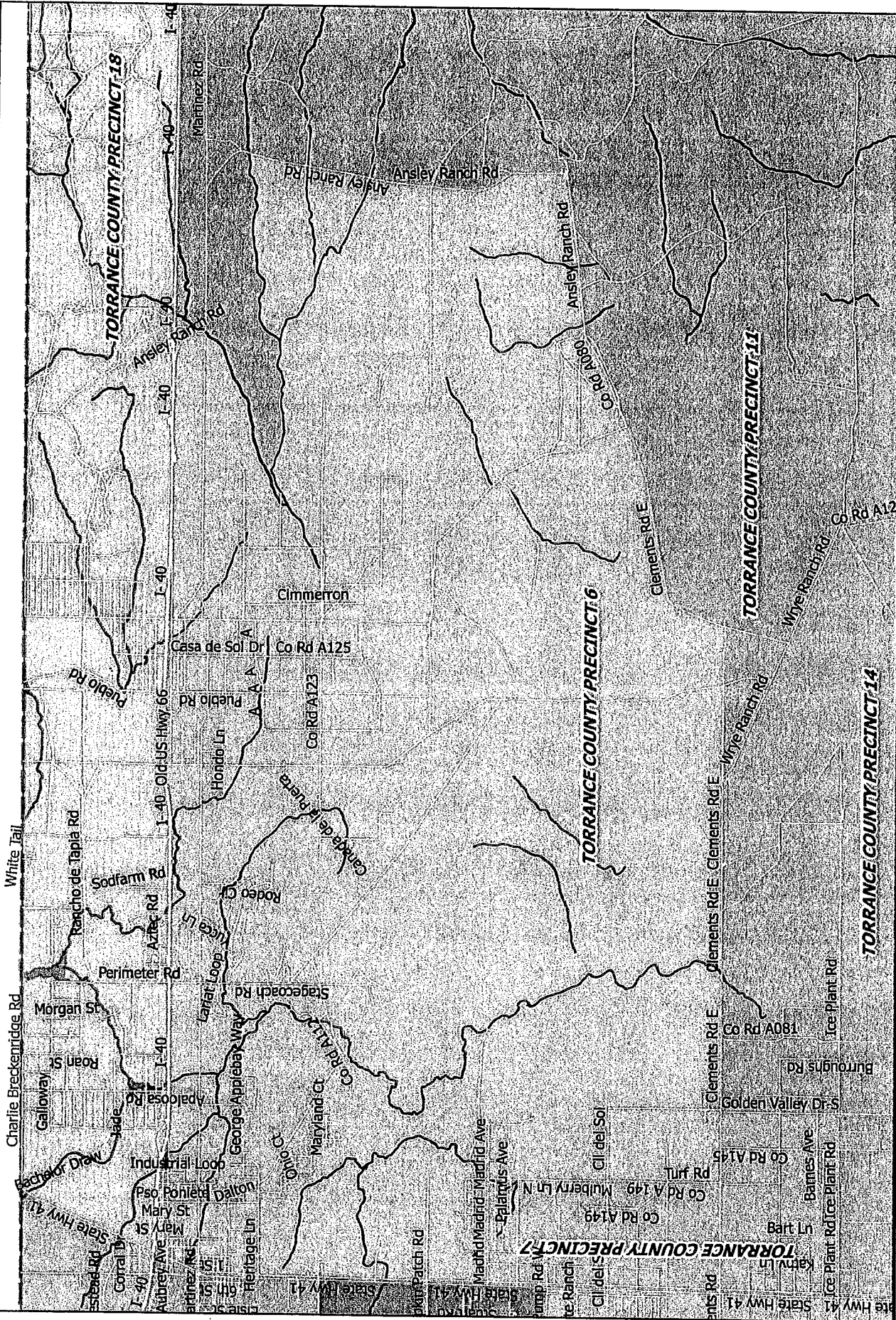

This map was compiled by Research & Polling, Inc., using data believed to be accurate; however, a degree of error is inherent in all maps. The maps are "AS-IS" without warranties of any kind, either expressed or implied. Research & Polling, Inc., assumes no legal liability or responsibility for the accuracy, completeness, or usefulness of any map, or for consequential and indirect damages arising from its use. Detailed on-the-ground surveys may differ from the maps. CDR

Torrance County Precinct 13

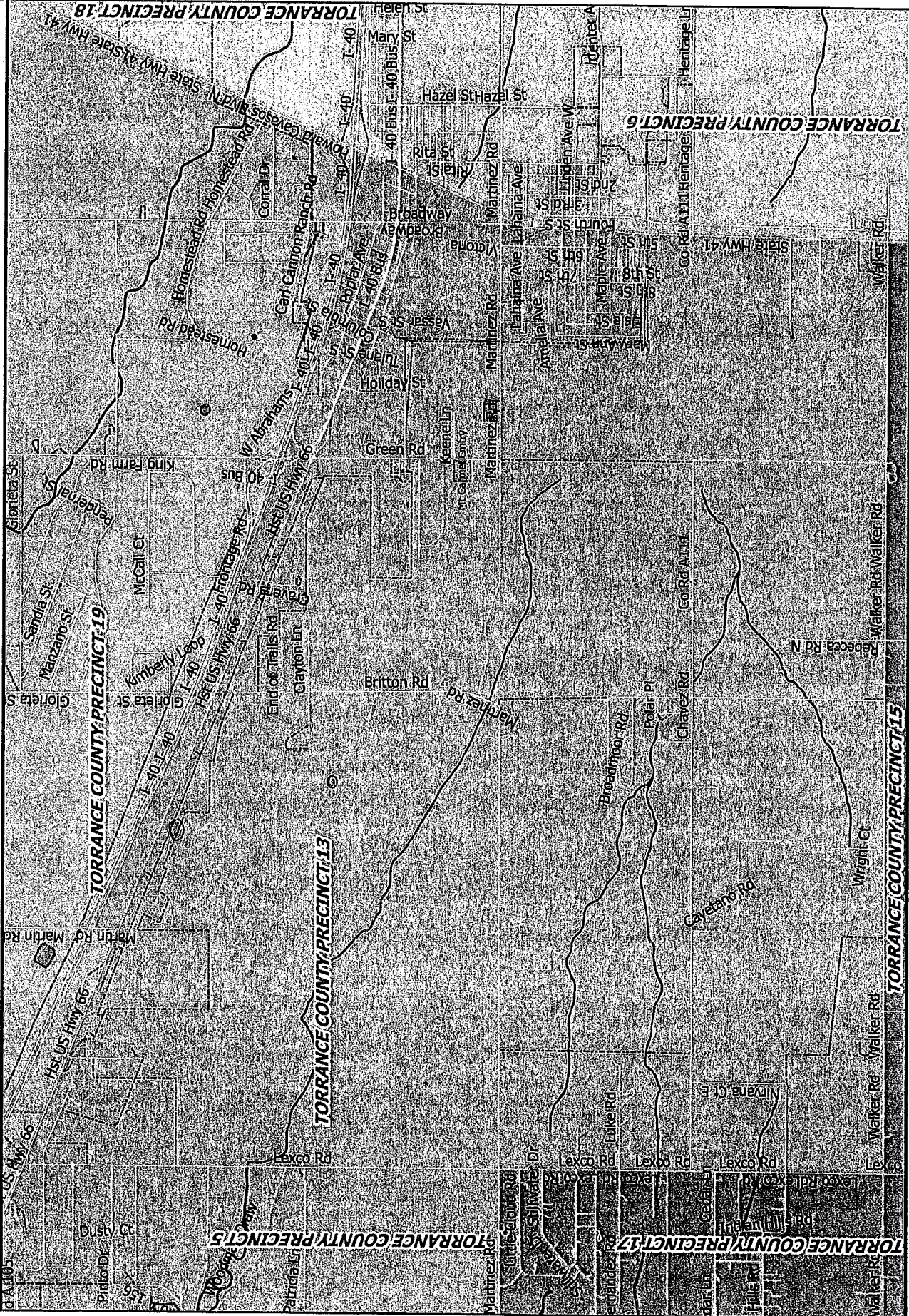

This map was compiled by Research & Polling, Inc. using data believed to be accurate; however, a degree of error is inherent in all maps. The maps are "AS-IS" without warranties of any kind, either expressed or implied. Research & Polling, Inc. assumes no legal liability or responsibility for the accuracy, completeness, or usefulness of any map, or for consequential and indirect damages arising from its use. Detailed on-the-ground surveys may differ from the maps. CDFR

Torrance County Precinct 17

Revised

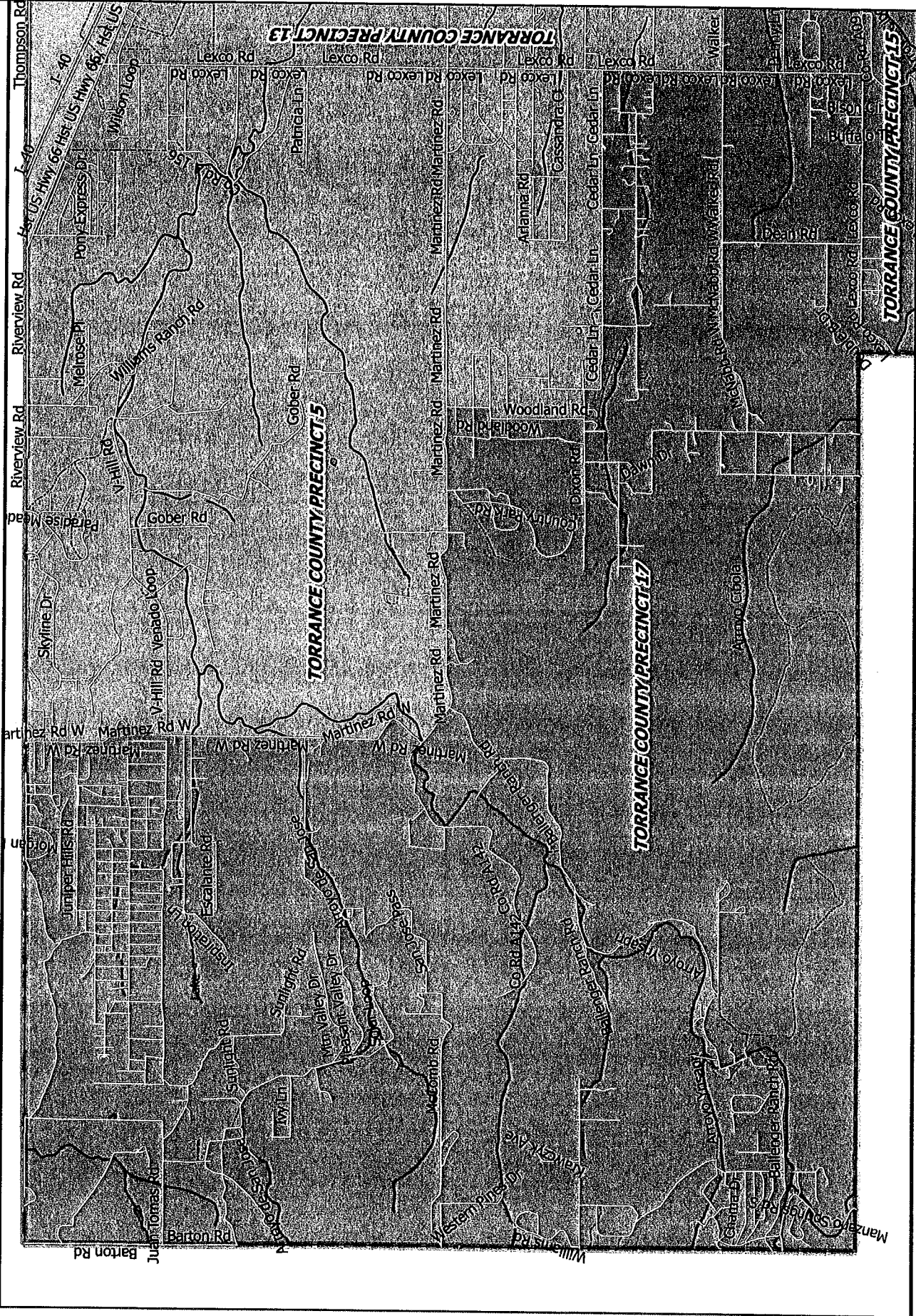

This map was compiled by Research & Polling, Inc., using data believed to be accurate; however, a degree of error is inherent in all maps. The maps are "AS-IS" without warranties of any kind, either expressed or implied. Research & Polling, Inc., assumes no legal liability or responsibility for the accuracy, completeness, or usefulness of any map, or for consequential and indirect damages arising from its use. Detailed on-the-ground surveys may differ from the maps. CDFR

Torrance County Precinct 18

Moriarty Area

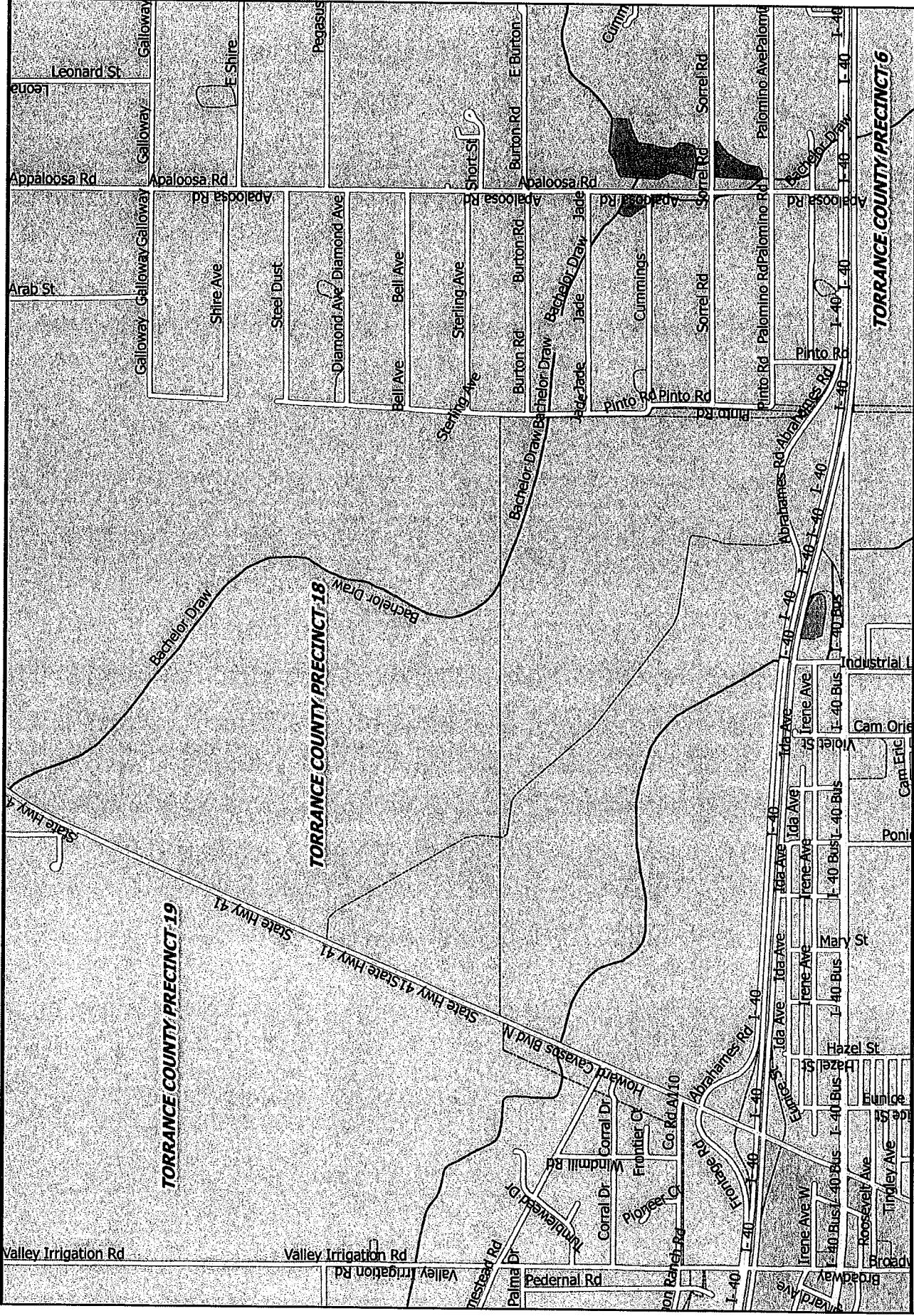

This map was compiled by Research & Polling, Inc., using data believed to be accurate; however, a degree of error is inherent in all maps. The maps are "AS-IS" without warranties of any kind, either expressed or implied. Research & Polling, Inc., assumes no legal liability or responsibility for the accuracy, completeness, or usefulness of any map, or for consequential and indirect damages arising from its use. Detailed on-the-ground surveys may differ from the maps. CDFR

Torrance County Precinct 18

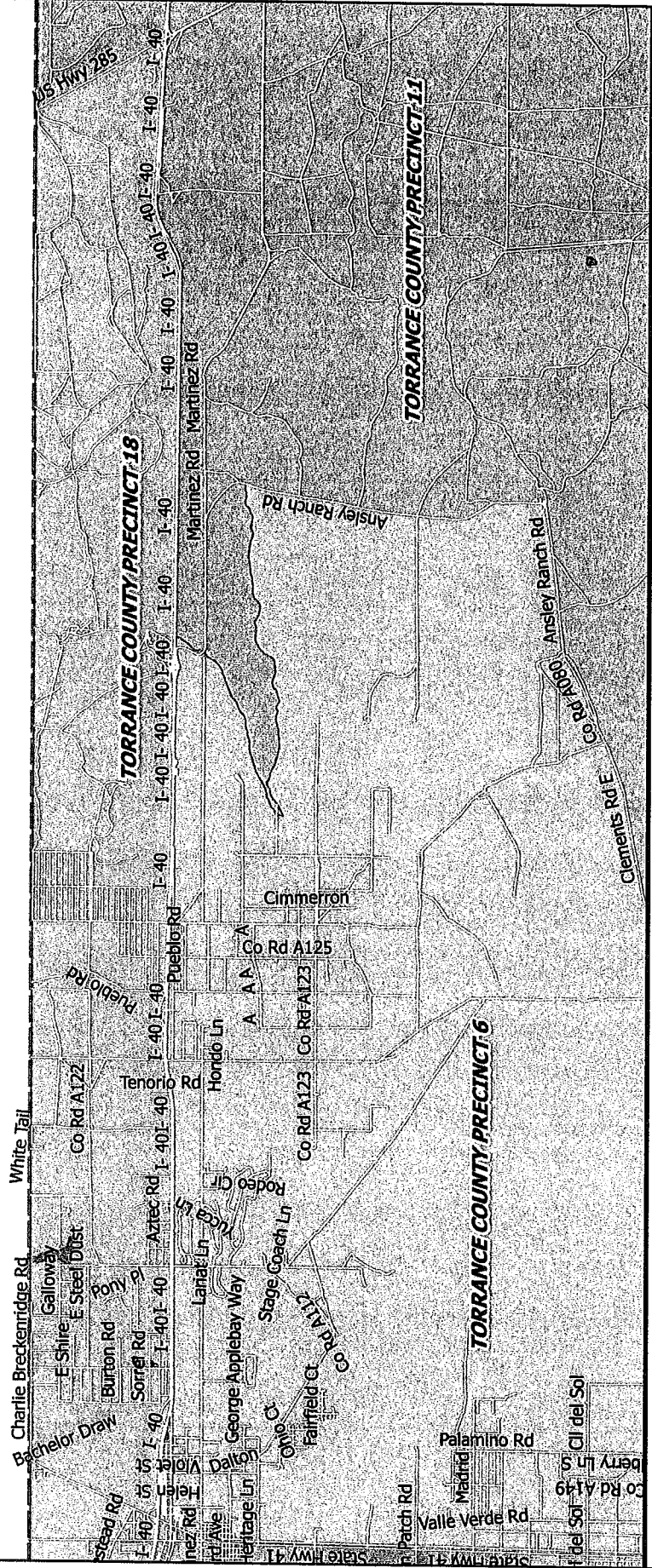

This map was compiled by Research & Polling, Inc., using data believed to be accurate; however, a degree of error is inherent in all maps. The maps are "AS-IS" without warranties of any kind, either expressed or implied. Research & Polling, Inc., assumes no legal liability or responsibility for the accuracy, completeness, or usefulness of any map, or for consequential and indirect damages arising from its use. Detailed on-the-ground surveys may differ from the maps. CDFR

0 8000 16000 24000 ft

May 20, 2019

Torrance County Precinct 19

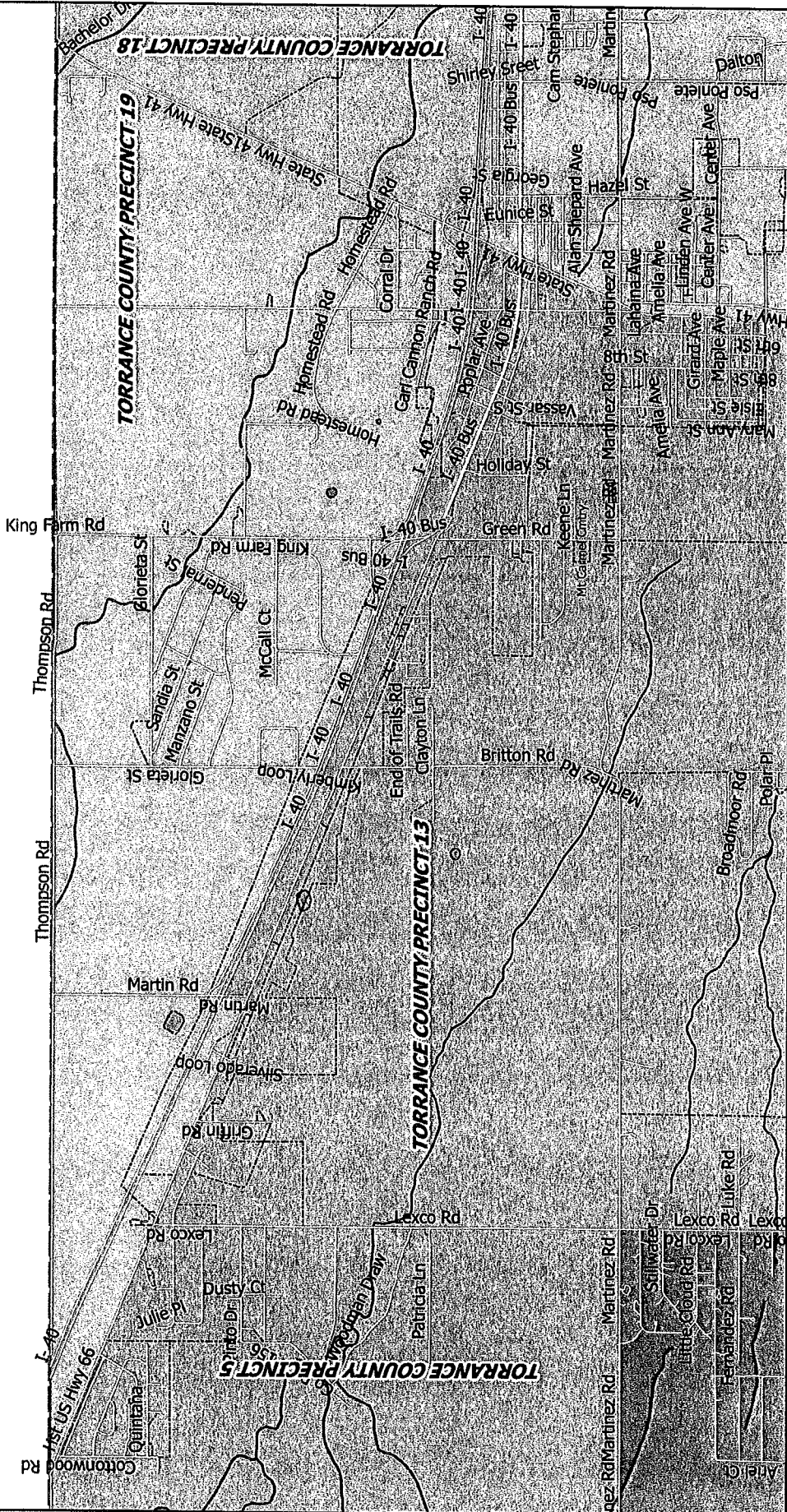

This map was compiled by Research & Polling, Inc. using data believed to be accurate; however, a degree of error is inherent in all maps. The maps are "AS-IS" without warranties of any kind, either expressed or implied. Research & Polling, Inc. assumes no legal liability or responsibility for the accuracy, completeness, or usefulness of any map, or for consequential and indirect damages arising from its use. Detailed on-the-ground surveys may differ from the maps. CDR

